

Your international network

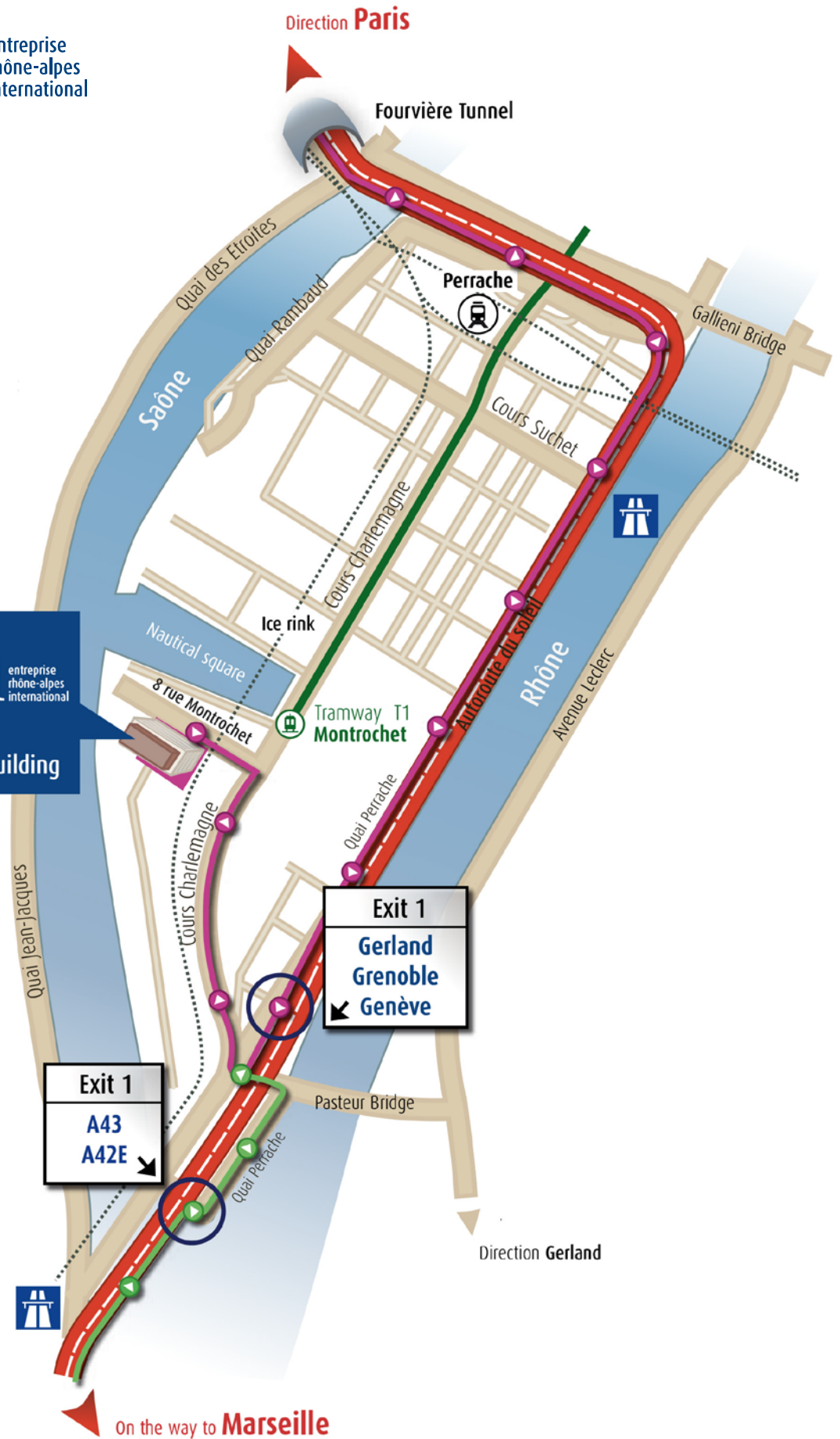

go@eraï.org
Tel : +33 4 26 73 33 66

ZAC Confluence
8 rue Paul Monrochet
CS 69285
69285 Lyon - France
www.eraï.org





go@eraï.org
Tel : +33 4 26 73 33 66

ZAC Confluence
8 rue Paul Montrochet
CS 69285
69285 Lyon - France
www.eraï.org

COMING FROM PARIS AND LYON, BY THE A6 MOTORWAY

- Continue on A7
- Take the exit N°1 Gerland/Grenoble/Geneva
- After the traffic light, turn right on *Cours Charlemagne*
- Take the 1st street on your left and stay on *Cours Charlemagne*

FROM "PERIPHERIQUE NORD" (called TEO)

- Before entering, follow A6 motorway *Paris-Roanne*
- In TEO, follow the way A6 motorway Paris, then take the exit Paris motorway A6
- Now, you are on the A6 motorway, continue on the A7 motorway

COMING FROM MARSEILLE, BY THE A7 MOTORWAY

- Take the exit N°1 towards A43/A42 *Porte de Gerland*
- Take the Perrache Bank
- Turn left on *Square Julien Gras*
- Turn right on *Cours Charlemagne*
- Go straight on *Cours Charlemagne*
- Take the 1st street on your left and stay on *Cours Charlemagne*

ACCESS BY TRAMWAY

Lyon 3rd district : Part-Dieu Vivier Merle Station

- Take the tramway T1 on the way to *Montrochet/Hôtel de Region* station
- Get off at the stop *Montrochet/Hôtel de Region* station

Lyon 2nd – Perrache Train Station

- Take the tramway T1 on the way to *Montrochet/Hôtel de Region* station
- Get off at the stop *Montrochet/Hôtel de Region* station